



FITZJOHN
SALES & LETTINGS

62 Hargate Way,
Hampton Hargate, Peterborough,
Cambridgeshire, PE7 8DS

Tel 01733 555520
info@fitzjohnstateagents.com
www.fitzjohnstateagents.com



16 Richardson Way Whittlesey Peterborough PE7 1RS

£750 Per month



First floor flat in the market town of Whittlesey, benefiting from new boiler, double glazed and two bedrooms. Accommodation comprises entrance hall, kitchen, lounge, bathroom and two bedrooms. NO SMOKERS & NO PETS. Available immediately. *** EARLY VIEWING IS HIGHLY RECOMMENDED ***

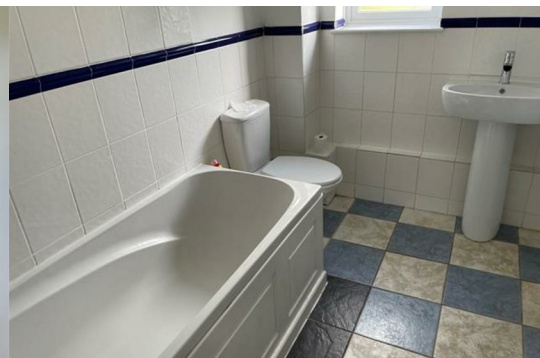

Entrance Hall

Tiled flooring, coving to textured ceiling, door to:

Bedroom 2 3.05m (10') x 2.34m (7'8")

Window to rear, radiator, fitted carpet, coving to textured ceiling.

Bedroom 1 4.17m (13'8") x 3.00m (9'10")

Window to front, radiator, wooden laminate flooring.

Living Room 4.27m (14') max x 4.17m (13'8")

Window to front, radiator, wooden laminate flooring, TV point, coving to textured ceiling.

Bathroom

Fitted with three piece suite comprising panelled bath with separate shower over, wash hand basin and low-level WC, tiled surround, heated towel rail, window to rear, tiled flooring.

Kitchen 3.81m (12'6") x 2.49m (8'2") max

Fitted with a matching range of base and eye level units with worktop space over, stainless steel sink unit with single drainer and mixer tap, plumbing for automatic washing machine, space for fridge, oven, four ring gas hob, window to rear, window to side, tiled flooring, door to cupboard.

Area Map



Floor Plans

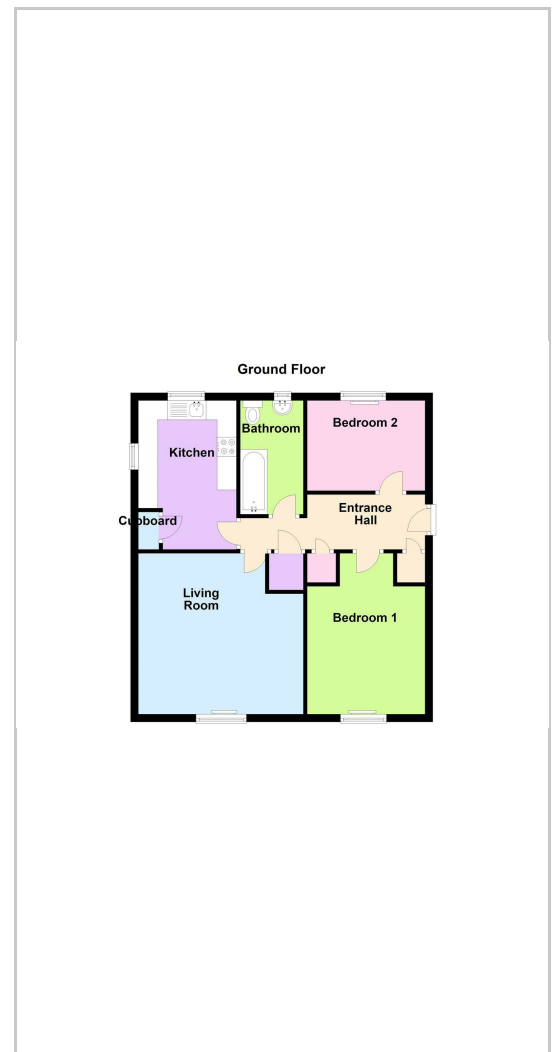

Energy Efficiency Graph

