



20 Fellowes Gardens Fletton Peterborough PE2 8DH

Offers in excess of £175,000



NO CHAIN with this well presented end terraced home located in the residential area of Fletton, within easy reach of the City Centre, bus routes and road links. The property offers three bedrooms, replacement windows and doors, refitted family bathroom, refitted flooring, kitchen diner and lounge. Outside is an enclosed garden to the rear and a single garage with parking to the rear. *** AN IDEAL FIRST TIME BUY/INVESTMENT PURCHASE ***



Entrance Hall 5.56m (18'3") x 1.81m (5'11")

Cloakroom 1.57m (5'2") x 0.82m (2'8")

Kitchen/Dining Room 5.56m (18'3") x 2.88m (9'5")

Lounge 4.79m (15'9") x 3.40m (11'2")

First Floor Landing

Bedroom 1 4.76m (15'7") x 2.88m (9'5")

Bedroom 2 4.21m (13'10") x 2.88m (9'5")

Bedroom 3 3.01m (9'10") x 1.81m (5'11")

Bathroom 2.50m (8'2") x 1.81m (5'11")

OUTSIDE

Enclosed low maintained garden to rear with panelled fencing and laid to gravel. Single garage to rear with up and over door, parking to rear.

*** If you are considering letting this property for a BUY TO LET please call Fitzjohn Property Rentals on 01733 555520. We can provide you free advice on all aspects of the lettings market including potential rental yields for this property ***

Area Map

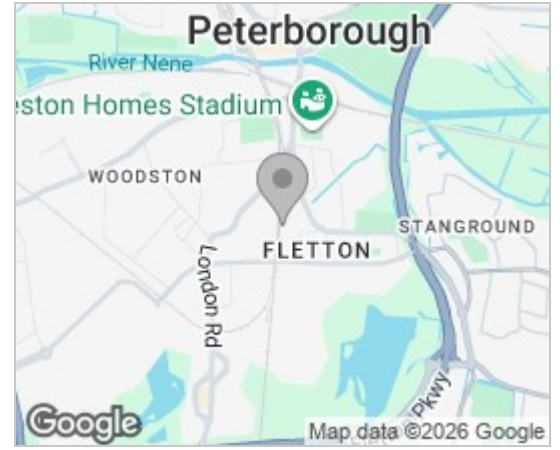

Floor Plans

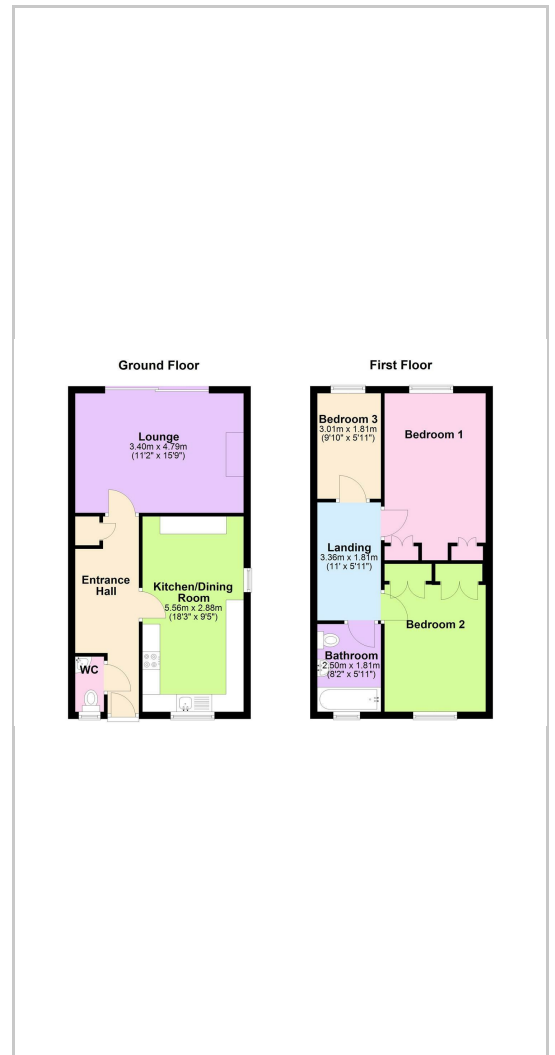

Energy Efficiency Graph

